



RE/MAX
Elite



Lifestyle House Melbourne Avenue, Sheffield, S10 2QH

£850

SPACIOUS ONE BEDROOM RETIREMENT APARTMENT – OVER 50s DEVELOPMENT – WATER & SERVICE CHARGE INCLUDED

This well-proportioned one-bedroom apartment is located within a purpose-built over 50s development. The property features a modern fitted kitchen, generous lounge/diner, double bedroom with fitted wardrobes and a contemporary shower room. Residents benefit from attractive communal gardens, shared lounge facilities, laundry room and a welcoming community environment. Water rates and service charge are included within the rent, offering excellent value and stress-free living.

Entrance Hall

Central hallway providing access to all rooms, with neutral décor and practical layout.

Lounge / Dining Room 18'0" x 9'10" (5.50m x 3.00m)

A bright and spacious main reception room with ample space for both lounge and dining furniture. Large window allows plenty of natural light, creating a welcoming and airy feel.

Kitchen 8'2" x 6'6" (2.50m x 2.00m)

Modern fitted kitchen comprising a range of wall and base units, contrasting work surfaces, tiled splashbacks, integrated oven, hob and extractor hood, plus stainless steel sink and drainer.

Bedroom 12'5" x 8'2" (3.80m x 2.50m)

Well-proportioned double bedroom featuring fitted mirrored wardrobes providing excellent storage. Large window offering natural light and pleasant outlook.

Shower Room 7'2" x 6'2" (2.20m x 1.90m)

Contemporary suite comprising walk-in shower enclosure, low-level WC and pedestal wash basin. Fully tiled walls for easy maintenance.

Communal Facilities

Residents benefit from:

Attractive landscaped communal gardens

Spacious residents' lounge

On-site laundry facilities

Well-maintained communal areas

Friendly and secure environment

Floor Plan

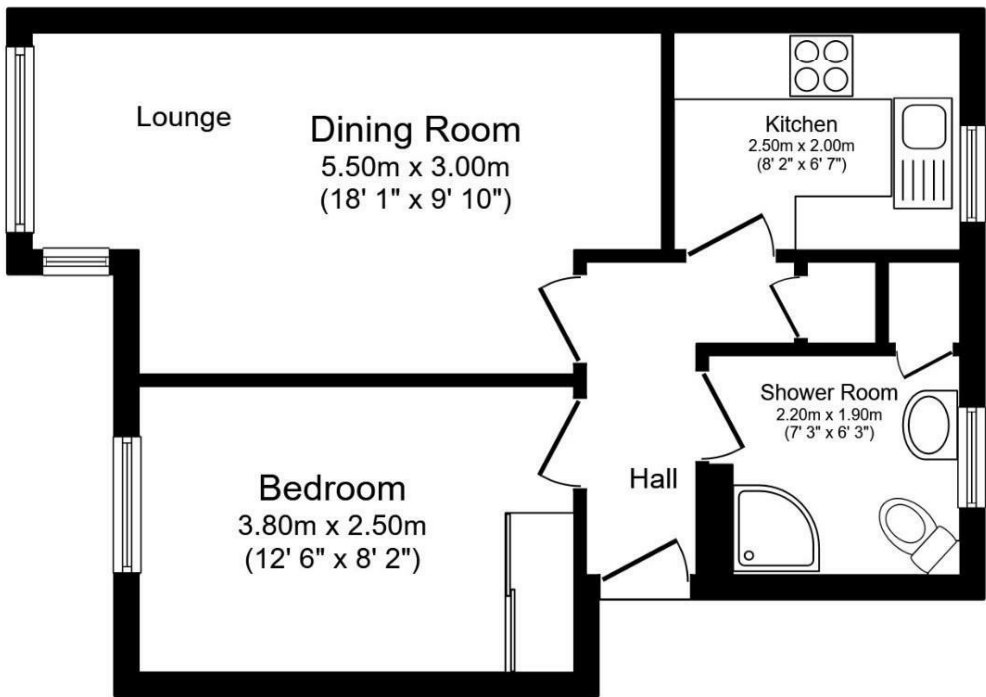

Floor Plan

Total floor area 39.1 sq.m. (420 sq.ft.) approx

This floor plan is for illustrative purposes only. It is not drawn to scale. Any measurements, floor areas (including any total floor area), openings and orientation are approximate. No details are guaranteed, they cannot be relied upon for any purpose and they do not form part of any agreement. No liability is taken for any error, omission or misstatement. A party must rely upon its own inspection(s).
Powered by www.focalagent.com

Area Map



Energy Efficiency Graph

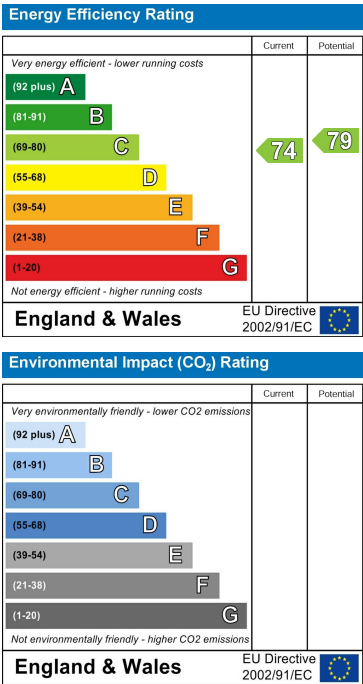

These particulars, whilst believed to be accurate are set out as a general outline only for guidance and do not constitute any part of an offer or contract. Intending purchasers should not rely on them as statements of representation of fact, but must satisfy themselves by inspection or otherwise as to their accuracy. No person in this firms employment has the authority to make or give any representation or warranty in respect of the property.